

MATTHEW JAMES

Residential Sales • Lettings • Management



Southside 32 Carleton Road, Tufnell Park, N7 0QH

£1,900 Per Calendar Month

We offer to let a lovely one double bedroom first floor purpose built flat forming part of this attractive low rise corner building approximately 10 minutes walk from both Kentish Town and Tufnell Park underground stations. Set within this popular environmental zone the property is also close to Camden Road which offers a quick bus ride into the heart of bustling Camden Town. Available from 04th June. Furnished

First Floor

Accessed through a communal hallway and staircase

Entrance Hall

Entry phone, large storage cupboard, laminate wood flooring.

Lounge



Laminate wood flooring, picture rail, casement window to front.

Kitchen



Wall and floor cupboards, stainless steel sink and drainer unit, fridge freezer, washing machine, dishwasher, electric hob and oven, casement window to rear.

Double Bedroom



Laminate wood flooring, picture rail, large wardrobe space, casement window to rear.

Bathroom / W.C.



White suite including panel enclosed bath with wall mounted shower attachment, ceramic pedestal wash basin, low level WC, partly tiled, opaque casement window to rear.

Exterior



Additional Information

Islington Council Tax Band C

Holding Deposit - Equivalent To 1 Weeks Rent eg. £438

Full Deposit - Equivalent To 5 Weeks Rent eg. £2,190 (to include holding deposit)

Floor Plan

Dalmeny Avenue,
 Southside, N7
 Approx. Gross Internal Area
 477 Sq Ft - 44.31 Sq M

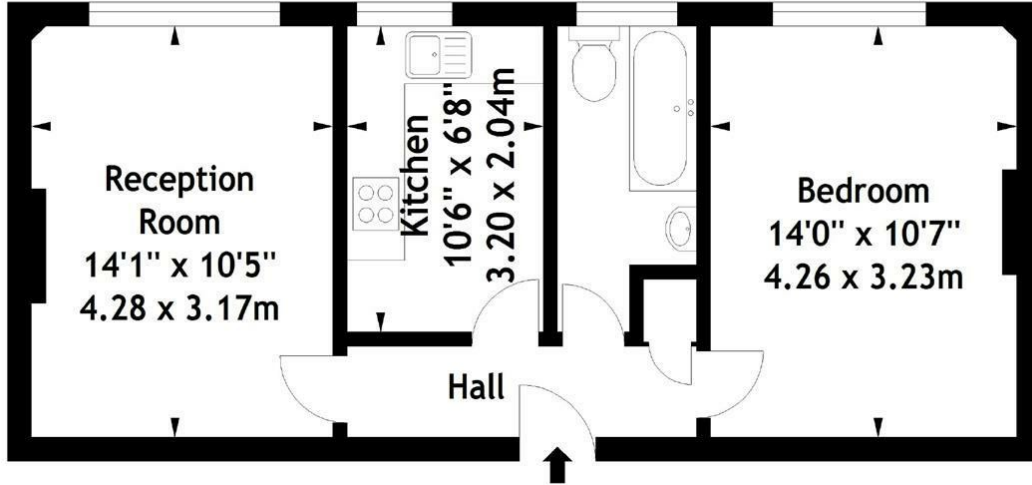

First Floor

Measured in accordance with RICS guidelines. Every attempt is made to ensure accuracy, however all measurements are approximate. This floor plan is for illustrative purposes only and is not to scale.
 © Datography Ltd 2014
 Photographs * Floorplans * Virtual Tours
 Tel: 0845 643 4401 www.datography.com

Area Map

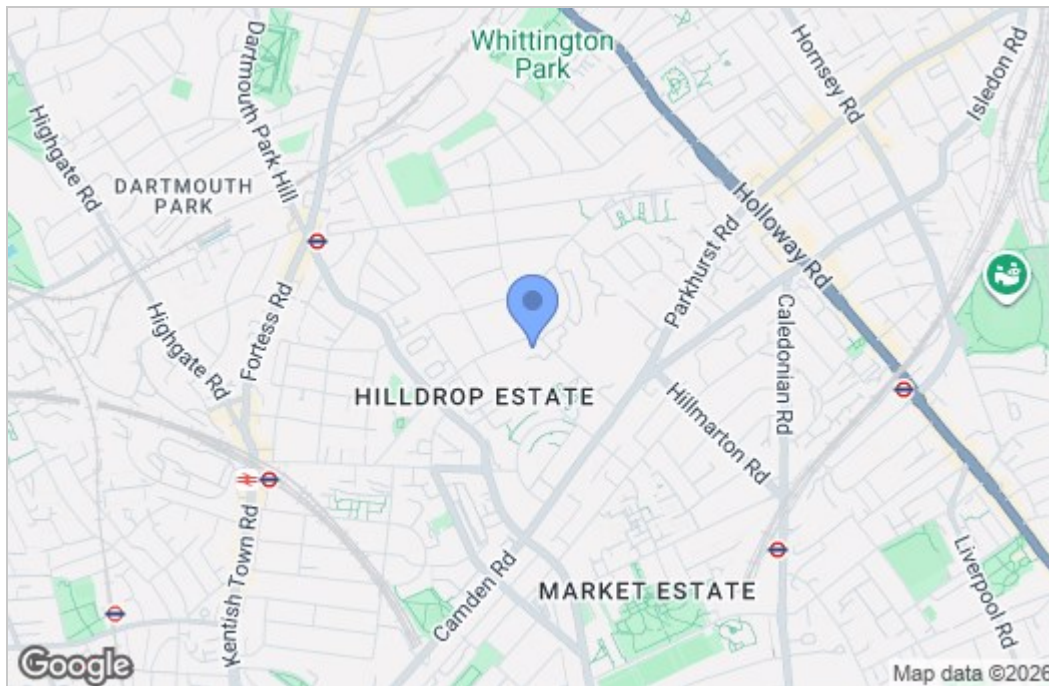

Energy Efficiency Graph

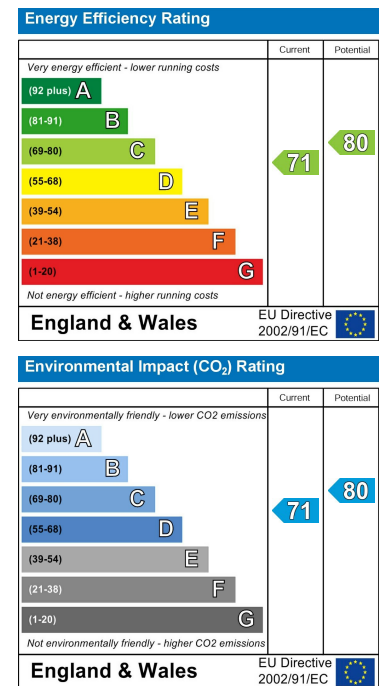

These particulars, whilst believed to be accurate are set out as a general outline only for guidance and do not constitute any part of an offer or contract. Intending purchasers should not rely on them as statements of representation of fact, but must satisfy themselves by inspection or otherwise as to their accuracy. No person in this firm's employment has the authority to make or give any representation or warranty in respect of the property.